



Metro

Los Angeles County  
Metropolitan Transportation  
Authority  
One Gateway Plaza  
3rd Floor Board Room  
Los Angeles, CA

## Board Report

---

**File #:** 2016-0735, **File Type:** Oral Report / Presentation

**Agenda Number:** 37

---

**SYSTEM SAFETY, SECURITY AND OPERATIONS COMMITTEE  
JANUARY 19, 2017**

RECEIVE oral report on System Safety, Security and Operations.

# Metro Rail Event-Day Service

*Rams Football, USC Football, Rose Parade & Rose Bowl*



# Metro Staffing

- **Metro provides general staffing for these events.**
  - *Rail & Bus Operations Support*
  - *Security: LASD & Metro Transit Security*
  - *Crowd Control Staff*
  - *Revenue Collections/TAP*
- **Key staffing locations for these events typically are...**
  - *7<sup>th</sup> /Metro Ctr*
  - *Union Station*
  - *Expo Park/USC*
  - *Expo/Vermont*
  - *37<sup>th</sup> Street*



# Rams Season Ridership / Increased Service

LA Rams Season Ridership Metro Bus/Rail				
Date	vs.	Ridership	Attendance	%
8/13/2016	Cowboys	10,600	80,000	13.25%
8/20/2016	Chiefs	12,200	61,000	20.00%
9/18/2016	Seahawks	21,000	80,000	26.25%
10/9/2016	Bills	18,000	70,400	25.57%
11/6/2016	Panthers	17,500	76,000	23.03%
11/20/2016	Dolphins	16,200	69,600	23.28%
12/11/2016	Falcons	14,500	66,300	21.87%
12/24/2016	49ers	12,700	66,600	19.07%
1/1/2017	Cardinals	11,900	58,000	20.52%

- **Rail Service**
  - *Increased capacity on Expo and Gold with 3-car trains.*
  - *Increased capacity on Red/Purple with 6-car trains.*
  - *Increased Headways 6-10 minutes.*
- **Bus Service**
  - *Silver Line Additional Buses*
  - *Expo Line Support Buses*



# Rams Football Event Planning & Crowd Control

- Coordination meetings held with key external stake-holders such as LADOT & LA Coliseum.
- Unique crowd control plans created for Expo Park/USC & Expo/Vermont Stations.
- Operations Plan Handbooks outline deployments strategies and staffing outlines.

## Rams Football Game Operations Plan

Rams vs. 49ers  
December 24, 2016

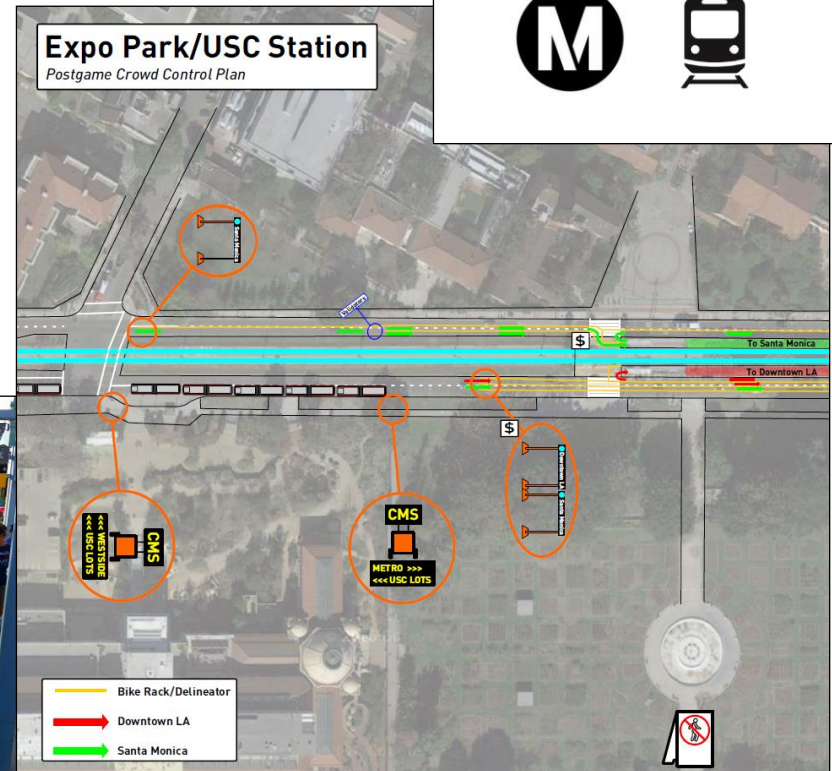

# Rose Parade/Bowl Planning & Crowd Control

- Coordination meetings held with key external stake-holders such as the City of Pasadena.
- Unique crowd control plans created for Memorial Park, Union Station and other Pasadena area Stations.
- Operations Plan Handbooks are distributed for each event to all affected departments outlining deployments and strategies.

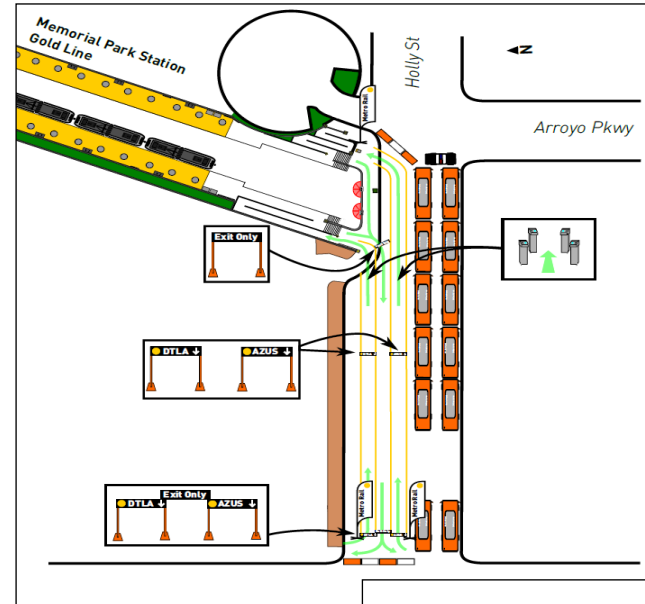

**Metro Rail**  
2016 New Year's Ops Plans

*Saturday, Dec 31<sup>st</sup> – Monday, Jan 2<sup>nd</sup>*  
*(New Year's Eve, New Year's Day, New Year's Day Observed)*

Includes...

- Downtown Long Beach NYE Ops
- Civic Center/Grand Park NYE Party
- New Year's Day Rams Football Game
- Pasadena Rose Bowl & Rose Parade





# Rose Parade – Memorial Park Station



# 2017 Football

- **Chargers announced their move to Los Angeles (Stubhub Center in Carson)**
- **Rail Operations will strive to maintain a zero incident record for the 2017 football season.**
- **Metro will continue to provide safe & reliable service.**
- **We will accept the challenge of growing ridership and meet the demand of system-wide special events.**

