



Metro

Los Angeles County
Metropolitan Transportation
Authority
One Gateway Plaza
3rd Floor Board Room
Los Angeles, CA

Board Report

File #: 2020-0741, **File Type:** Informational Report

Agenda Number: 7.

**MEASURE R INDEPENDENT TAXPAYERS OVERSIGHT COMMITTEE
November 4, 2020**

SUBJECT: RECEIVE Oral Report on Transit and Highways

ACTION: ORAL REPORT

RECOMMENDATION

Oral Report on Transit and Highways

Program Management Major Transit Project Status Report

Presented By

Brian Boudreau

Senior Executive Officer, Project Management Oversight

November 4, 2020

Measure R Oversight Committee
Los Angeles County Metropolitan Transportation Authority



CRENSHAW/LAX TRANSIT PROJECT

◆ BUDGET

| | <u>Current</u> | <u>Forecast</u> |
|------------|----------------|-----------------|
| TOTAL COST | \$2,148M | \$2,148M |

▲ SCHEDULE

| | <u>Current</u> | <u>Forecast</u> |
|-------------------|----------------|-----------------|
| REVENUE OPERATION | May 2021 | TBD - 2021 |

- Overall Project Progress is 96.4% complete.
- Contractor continues work on all stations and street work restoration/landscaping across Project.
- Concerned that Contractor is not applying sufficient work force to complete their remaining work and their systems testing by December 2020.



Excavating/removing section of pavement for restoration on southbound Crenshaw Blvd. and 54th St.



Continue installing supports and fixture for crossover lighting at the invert level of Expo/Crenshaw Station.



On target



Possible problem



Major issue

REGIONAL CONNECTOR TRANSIT PROJECT

BUDGET

| | <u>Current</u> | <u>Forecast</u> |
|------------|----------------|-----------------|
| TOTAL COST | \$1,816M | \$1,816M |

SCHEDULE

| | <u>Current</u> Summer/Fall 2022 | <u>Forecast</u> Summer/Fall 2022 |
|----------------------|---------------------------------------|--|
| REVENUE OPERATION | | |

- Overall Project Progress is 70% complete.
- Little Tokyo/Arts District Station & Surrounding Area:** Final preparations underway for decommissioning Gold Line Little Tokyo/Arts District Station scheduled to begin October 24th.
- Historic Broadway Station:** Entrance structure construction advancing as planned.
- Grand Av Arts/Bunker Hill Station:** Structural concrete, MEP and systems installation continues throughout the Station.
- Flower Street:** Installation of final walls and roof continue for tie-in to 7th/Metro Station.



Direct Fastener plates and track assembled in left tunnel reach 2



Aluminum shoring installation for roof deck at the future



On target



Possible problem



Major issue

WESTSIDE PURPLE LINE EXTENSION – SECTION 1

BUDGET

| | <u>Current</u> | <u>Forecast</u> |
|--------------------|-----------------|-----------------|
| TOTAL COST* | \$3,354M | \$3,354M |

* Includes Board approved LOP budget plus finance costs.

SCHEDULE

| | <u>Current</u> | <u>Forecast</u> |
|---------------------------|-------------------------|------------------|
| REVENUE OPERATIONS | Fall 2024 (FFGA) | Fall 2023 |

- Overall Project Progress is 64% complete.
- Wilshire/Western Retrieval Shaft:** Continued support of Reach 1 cross passage construction. Break through into Wilshire/Western Station continues.
- Wilshire/La Brea Station:** Station structure concrete work continues including 2nd lift exterior walls and concrete roof placement. Concrete for the first set of permanent stair was placed on September 4, 2020.
- Wilshire/Fairfax Station:** The first concourse concrete placement (Block 10) occurred on August 22, 2020. Entrance plaza structure and appendage work continue.
- Wilshire/La Cienega Station:** Structural concrete placement continues. The first 2nd lift wall placement in the high bay area (Block 10) was completed on September 11, 2020.
- Tunneling:** As of September 13, 2020, the Purple TBM (Elsie) has mined 1,992 feet (61% complete) and the Red TBM (Soyeon) has mined 1,734 feet (53% complete) of the Reach 3 tunnel.
- Reach 1 Tunnel Cross Passages (CP):** 6 out of 12 cross passages have been excavated. Concrete placement of the 1st cross passage is complete (CP#11). Work continues at all other cross passages. Completion anticipated in February 2021.
- Reviewing any impacts differing site conditions and third party requirements may have on the project schedule.



Wilshire/Fairfax Station concourse rebar installation



View of Reach 1 Cross Passage #8



On target



Possible problem



Major issue

WESTSIDE PURPLE LINE EXTENSION – SECTION 2



BUDGET

| | <u>Current</u> | <u>Forecast</u> |
|--------------------|-----------------|-----------------|
| TOTAL COST* | \$2,530M | \$2,530M |

* Includes Board approved LOP budget plus finance costs.



SCHEDULE

| | <u>Current</u> Winter 2026 (FFGA) | <u>Forecast</u> Summer 2025 |
|------------------------------|---|-----------------------------------|
| REVENUE OPERATION | | |

- Overall Project progress is 36% complete.
- **Century City Constellation Station**
 - Pile installation in Constellation Blvd west of the launch box is anticipated to be complete by November 2020.
 - Decking operations west of the launch box are anticipated to be complete by Thanksgiving 2020.
- **Wilshire/Rodeo Station**
 - Excavation of the station box was 50% completed as of late September 2020.
- **Tunneling**
 - The abandonment of the two legacy oil wells by BHUSD’s contractor is ongoing with oversight by CalGEM. Both wells are in the path of the BR tunnel. Abandonment of the first well was completed in September 2020.
 - The BL TBM (Ruth) entered the tunnel access shaft in September 2020.
 - The re-launch of the BR TBM (Harriet) will occur after completion of the oil well abandonment work by BHUSD.
 - Tunneling operations will be transitioned to the access shaft after each TBM passes through the shaft.



Pile installation west of the launch box in Century City



Excavation of station entrance in Beverly Hills



On target



Possible problem



Major issue

WESTSIDE PURPLE LINE EXTENSION – SECTION 3

BUDGET

| | <u>Current</u> | <u>Forecast</u> |
|--------------------|-----------------|-----------------|
| TOTAL COST* | \$3,611M | \$3,611M |

* Includes Board approved LOP budget plus finance costs.

SCHEDULE

| | <u>Current</u> | <u>Forecast</u> |
|--------------------------|---------------------------|--------------------|
| REVENUE OPERATION | Winter 2028 (FFGA) | Spring 2027 |

- Overall Project progress is 14% complete.
- Final design progress is 68% complete.
- **C1151 Tunnel Contract**
 - BM No.1 has been assembled in the tail track exit shaft (launch shaft); starter gantry to follow.
 - TBM launch seal and headwall are complete.
 - So Cal Edison completed their work to provide power to operate the TBMs.
 - Fabrication of tunnel precast concrete liners are ongoing.
 - Installation of instrumentation and monitoring equipment are ongoing..
- **C1152 Stations, Trackwork and Systems Contract**
 - Final design is ongoing.
 - Relocation of the Stone Canyon Storm Drain at the Westwood/UCLA Station parking Lot 36 site has been completed.
 - VA parking lots refurbishment for temporary displaced parking during construction and electrical service conduit for the station is ongoing.
- **Other Third Party Utility Relocation Work**
 - Joint trench activities for combining Verizon and Frontier telecommunications remaining work, cable pulling/splicing, is anticipated to complete by Oct 30, 2020.



TBM Launch Cradle at base of excavated tail track exit shaft.



Reinforced concrete boxes for storm drain relocation.

 On target  Possible problem  Major issue

METRO MEASURE R OVERSIGHT COMMITTEE HIGHWAY PROGRAM PROGRESS UPDATE NOV. 2020



Abdollah Ansari
Sr. Executive Officer – Highway Program



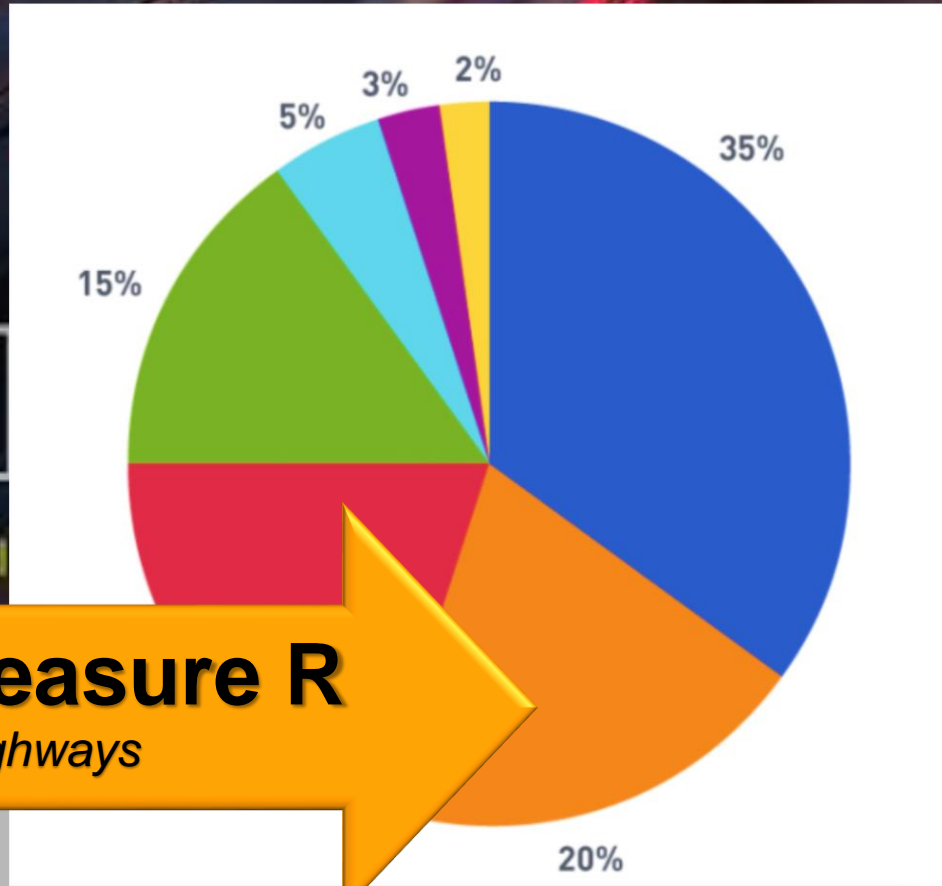



Measure R



Measure R
Highways



Expenditure Plan

| | |
|---|----------------------------------|
|  | Rail and Rapid Transit Expansion |
|  | Highway Improvements |
|  | Bus Operations |
|  | Local Return Improvements |
|  | Rail Operations |
|  | Metrolink Capital |
|  | Metro Rail Capital |



Metro

Measure R Highway Projects



Progress

2

- *I-5 HOV Lanes; SR-14 to Parker Road*
- *I-605/South Street Interchange Improvements*

Construction Ready

Construction Ready

3

- *I-710 Early Action Projects (Soundwalls)*

Design & Construction

7

- *SR-57/SR-60 Interchange Improvements*
- *SR-138 Widening, Rancho Vista Blvd. to Palmdale Blvd.*
- *SR-138/SR-14 10th Street West Interchange*
- *SR-138 (Palmdale Blvd.), 5th St. to 10th Street East*
- *SR-138/SR-14 Avenue M Interchange*
- *SR-91 WB widening between Shoemaker and I-605*
- *SR-72, Whittier Blvd. @Painter and S.F. Springs Rd.*

Design

Design

Design

Design

Design

Design

Design



Metro

Progress

5

- *SR-60/7th Avenue Interchange Improvements* Env. & Design
 - *SR-91 Widening, Eastbound, Atlantic to Cherry* Env. & Design
 - *SR-91/Central Avenue Improvements* Env. & Design
 - *I-605/Beverly Blvd. Interchange Improvements* Env. & Design
 - *I-605/Valley Blvd. Interchange Improvements* Env. & Design
-

10

- *SR-138/SR-14 SB Ramps at Palmdale Blvd.* Environmental
- *SR-138/SR-14 Avenue G Interchange* Environmental
- *SR-138/SR-14 Avenue J Interchange* Environmental
- *SR-138/SR-14 Avenue K Interchange* Environmental
- *SR-138/SR-14 Avenue L Interchange* Environmental
- *SR-138/SR-14 Avenue N Overcrossing* Environmental
- *I-405 NB and SB Imp., I-405 to Artesia Blvd.* Environmental
- *I-605 Corridor Between I-105 and I-10 Improvements* Environmental
- *I-710/Shoemaker Bridge Replacement* Environmental
- *I-710 Corridor Improvements* Environmental



Metro

Upcoming

- | | |
|---|--|
| <ul style="list-style-type: none">• <i>Local Streets/Intersections</i> | <i>Var. Phases</i> |
| <hr/> | |
| <ul style="list-style-type: none">• <i>Freight Advanced Traveler Information System</i> | <i>Study/Technology Implementation</i> |
| <hr/> | |
| <ul style="list-style-type: none">• <i>SR-710 Mobility Improvement Projects</i>• <i>I-710 Early Action Projects (Interchanges)</i> | <i>Not started yet</i> <i>Not started yet</i> |

I-5 North HOV and Truck Lanes



- 14 miles of HOV lanes in both directions
- 2 miles of truck climbing lanes at the south end
- 7 bridge modifications at:
 - Gavin Canyon
 - Calgrove Blvd.
 - Butte canyon
 - Magic Mountain Pkwy.
 - Santa Clara OH
 - Rye Canyon
 - Castaic Creek Bridge
- 1 bridge replacement at Weldon Canyon
- Soundwalls and retaining walls
- Completion of design: 2019
- [Construction advertising in November 2020](#)

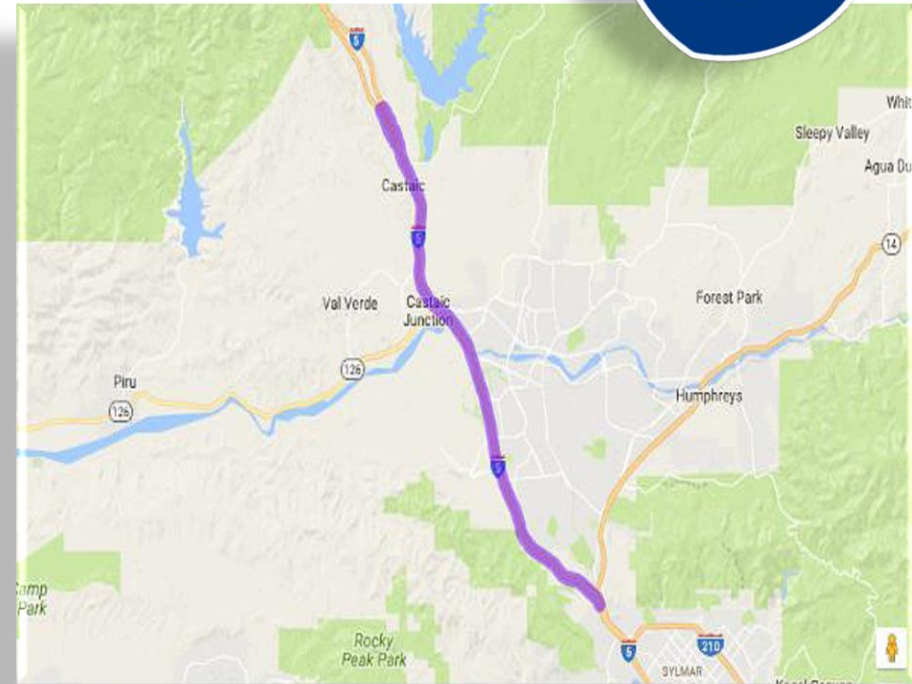

SR-57/SR-60 Interchange

- Metro Measure M Project
- Metro Call For Projects – In Progress
- Metro Call For Projects – In Progress
- Future Project



HOV to HOV Connector



Construction: 2022



I-605

Project Summary

- Freeway widening/additional lanes, ExpressLanes, ramp reconfigurations, arterial intersection enhancements, signage, and safety features
- Estimated total cost of projects in the I-605 corridor between I-105 and I-10: \$5+ billion

Status Update

- Corridor environmental studies in progress – completion in 2021
- PIDs, environmental clearance, and final design in progress for various “Early Action” projects
- One project is ready for construction

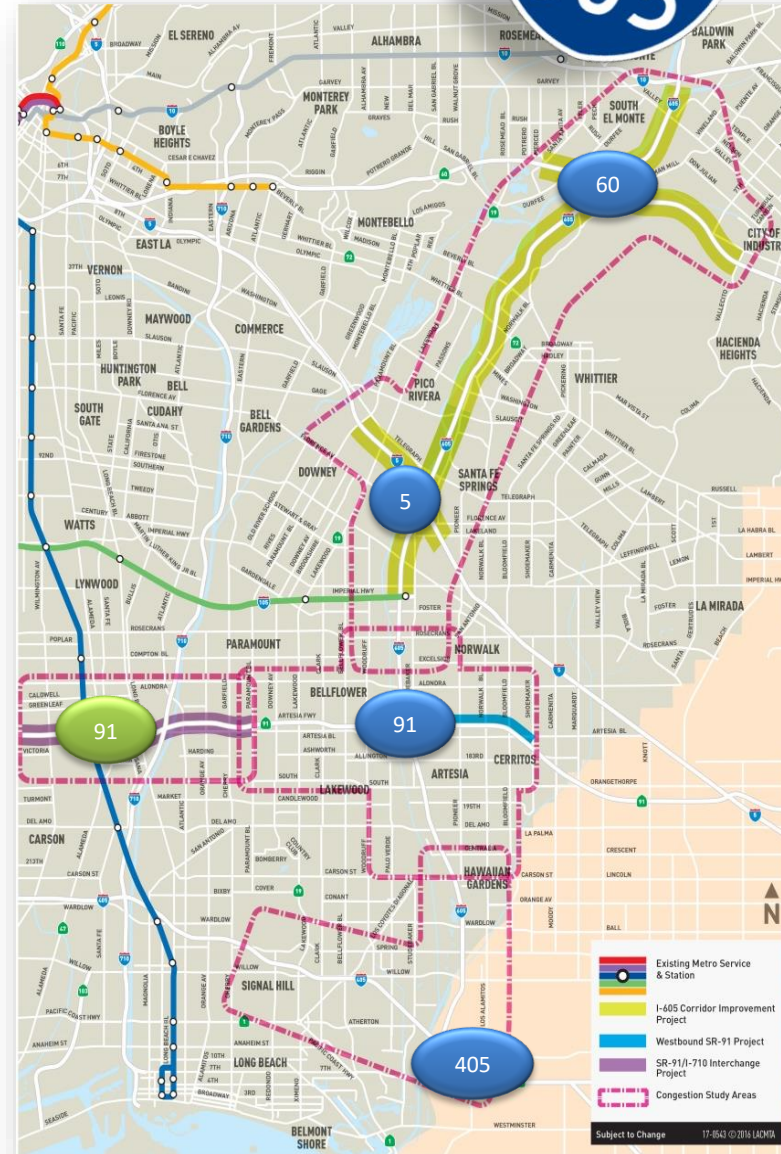

"Hot Spots" Program

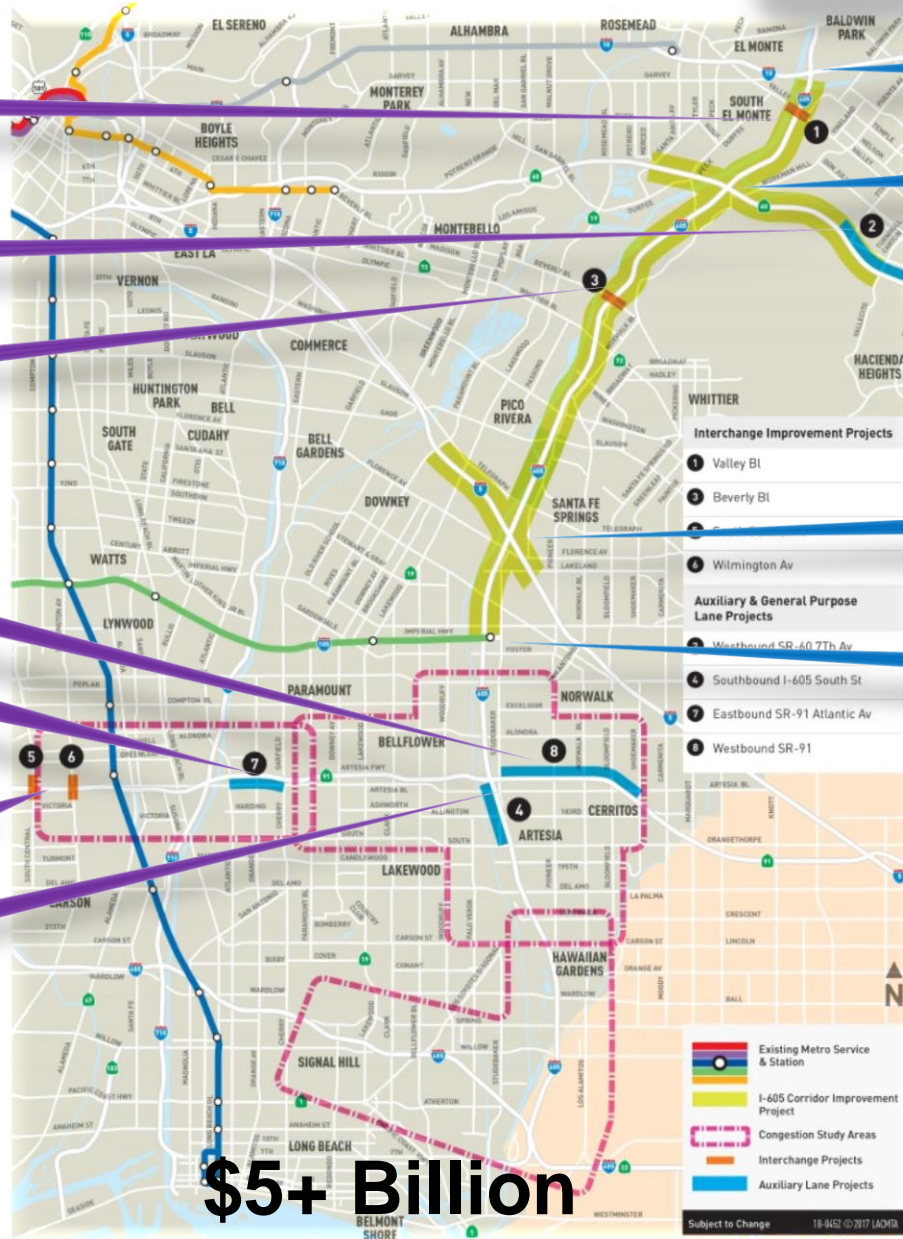

I-605/Valley Blvd.
Construction in 2022

SR-60/7th Ave.

I-605/Beverly Blvd.
Construction in 2021

WB-91 Alondra to
Shoemaker

SR-91 Atlantic to
Cherry

SR-91 Central to
Acacia

I-605/South St.
Construction in 2021

I-605/I-10

I-605/SR-60

I-605/I-5

I-605/I-105

+ Over 30 Arterial
Intersection
Improvements



\$5+ Billion

I-710



Project Summary

- In PAED phase
- 18 miles between the Ports of Long Beach and Los Angeles and the SR-60
- Locally-Preferred Alternative Selected:
 - 5C: One lane + upgrading
- Estimated Cost: \$6-\$11 billion
- Includes “Early Action” Projects
- \$420 mil in Measure R and \$500 mil. in Measure M

Status Update

- Final EIR/EIS: TBD
- Early Action projects final design starting upon approval of the final ED and contingent upon no legal action preventing progress



Metro

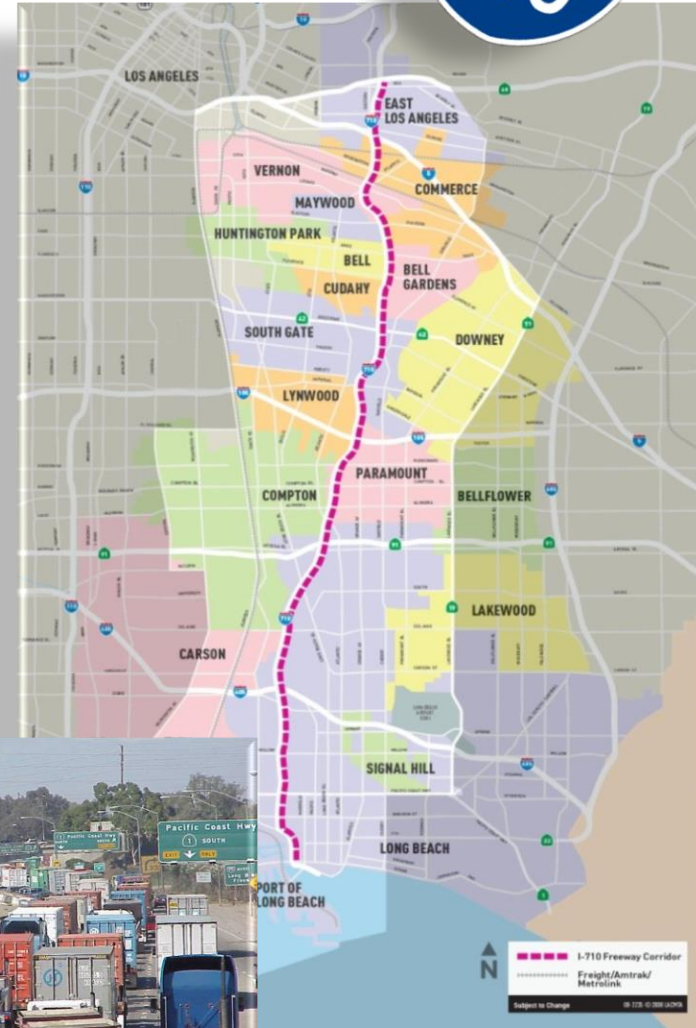

Early Action Projects



Project prioritization through collaboration with the corridor cities/GCCOG



SR-710



Project Summary

- \$780M in Measure R funds
- \$300+M in other funds
- PAED Completed
- Preferred Alternative selected:
Transportation System
Management/Transportation Demand
Management (TSM/TDM)
- Mobility improvement projects (MIP)
identified for funding and implementation

Status Update

- FED and ROD approved/signed
- Programming of approved TSM/TDM
and MIPs in 2019-20

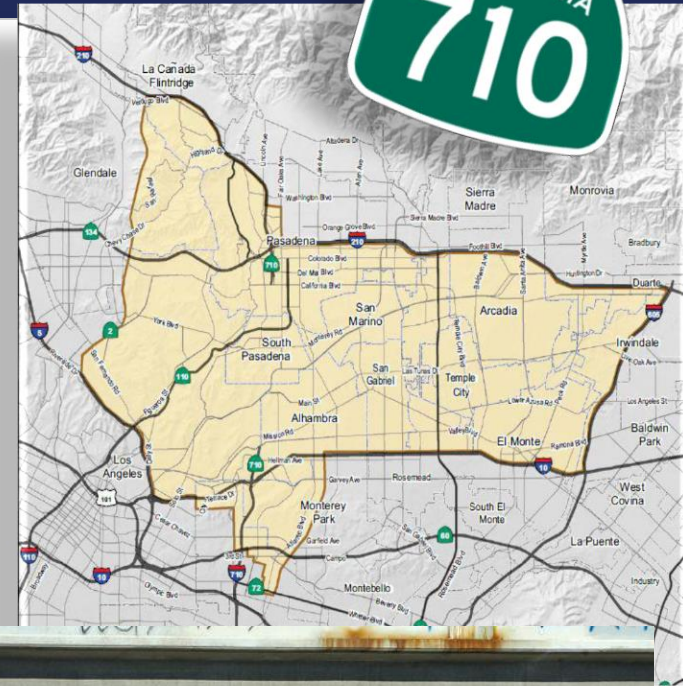

I-405



Project Summary

- Add auxiliary lanes NB & SB from I-105/I-405 to Artesia Blvd off-ramp

Status Update

- PSR completed Nov. 2018
- PAED commenced in March 2019
- Construction in 2023

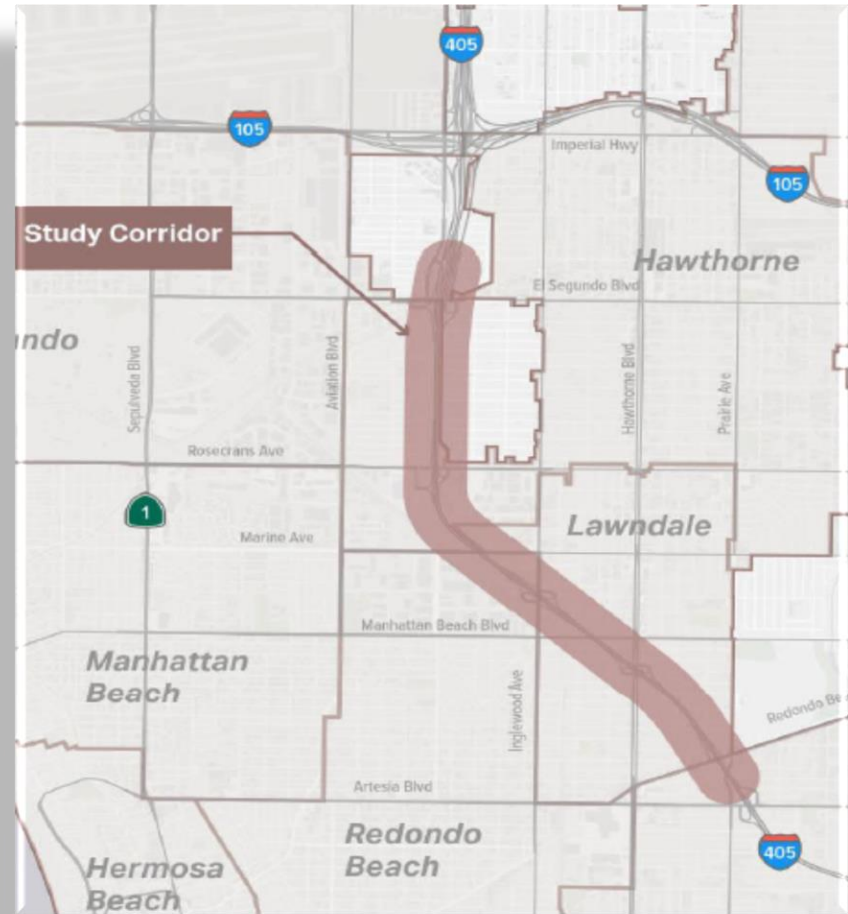

Metro

M.R. SR-14/138 Projects



| | Project | Construction Date (Estimate) |
|-----------|---|------------------------------|
| Lancaster | SR-138/SR-14 Avenue K Interchange | February 2022 |
| | SR-138/SR-14 Avenue G Interchange | March 2021 |
| | SR-138/SR-14 Avenue J Interchange | October 2020 |
| | SR-138/SR-14 Avenue L Interchange | January 2022 |
| | SR-138/SR-14 Avenue M Interchange | January 2022 |
| Palmdale | SR-138/Palmdale Blvd., 5th to 10th Street East | October 2021 |
| | SR-138/Palmdale Blvd., SB SR-14 Ramps | January 2021 |
| | SR-138, 10th Street West Interchange | August 2022 |
| | SR-138 Widening, Rancho Vista Blvd. to Palmdale Blvd. | In Const. (11/2018) |
| | SR-138, Avenue N Overcrossing | May 2022 |

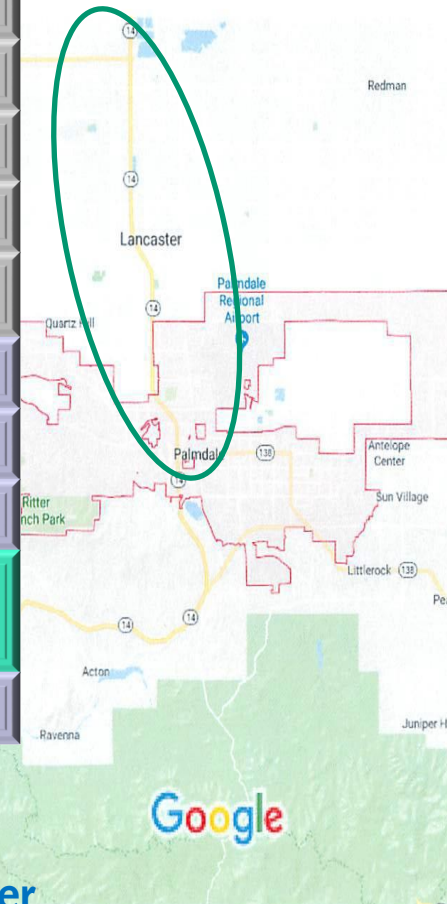

Construction contracts by Palmdale and Lancaster

High Desert Corridor



Project Summary

- 63 miles - Highway, Expressway, Tollway, High Speed Rail, Bikeway, and energy production/transmission corridor concepts
- Connecting North Los Angeles County and San Bernardino County (Victorville)
- Transit connection between the CHSR and the XpressWest
- In Measure M for ROW and related services in 2019
- More funds in later years
- Final EIR/EIS completed in 2016

Status Update

- Multi-agency efforts in assessing other feasible alternatives
 - Highway
 - rail



Metro

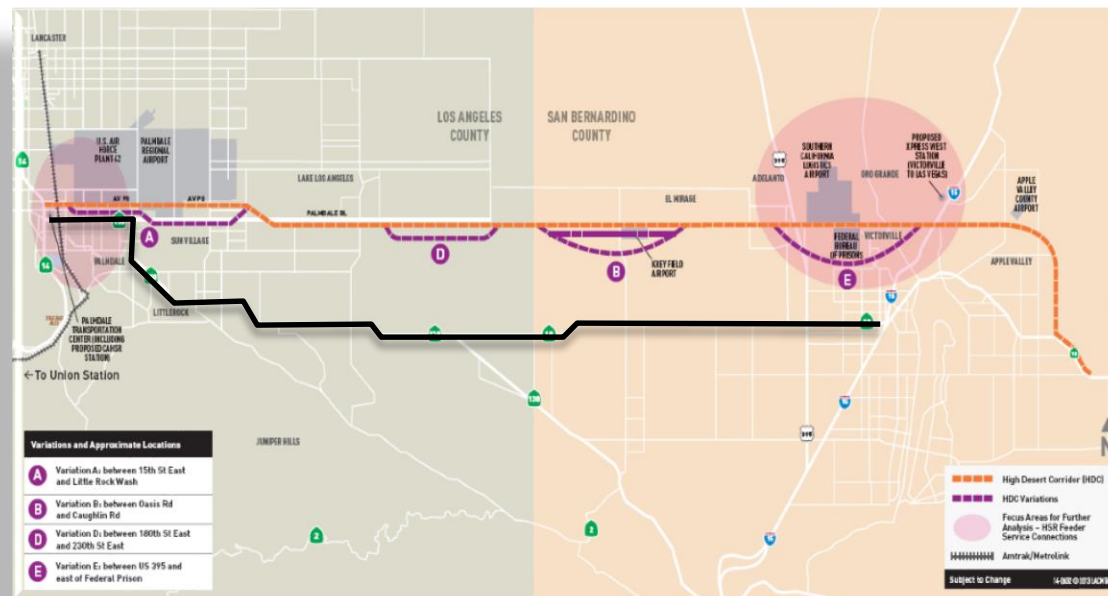

SR-138, SR-14 to LA/SB County Line



CALTRANS PROJECTS ON ROUTES 14 AND 138 IN LOS ANGELES AND SAN BERNARDINO COUNTIES

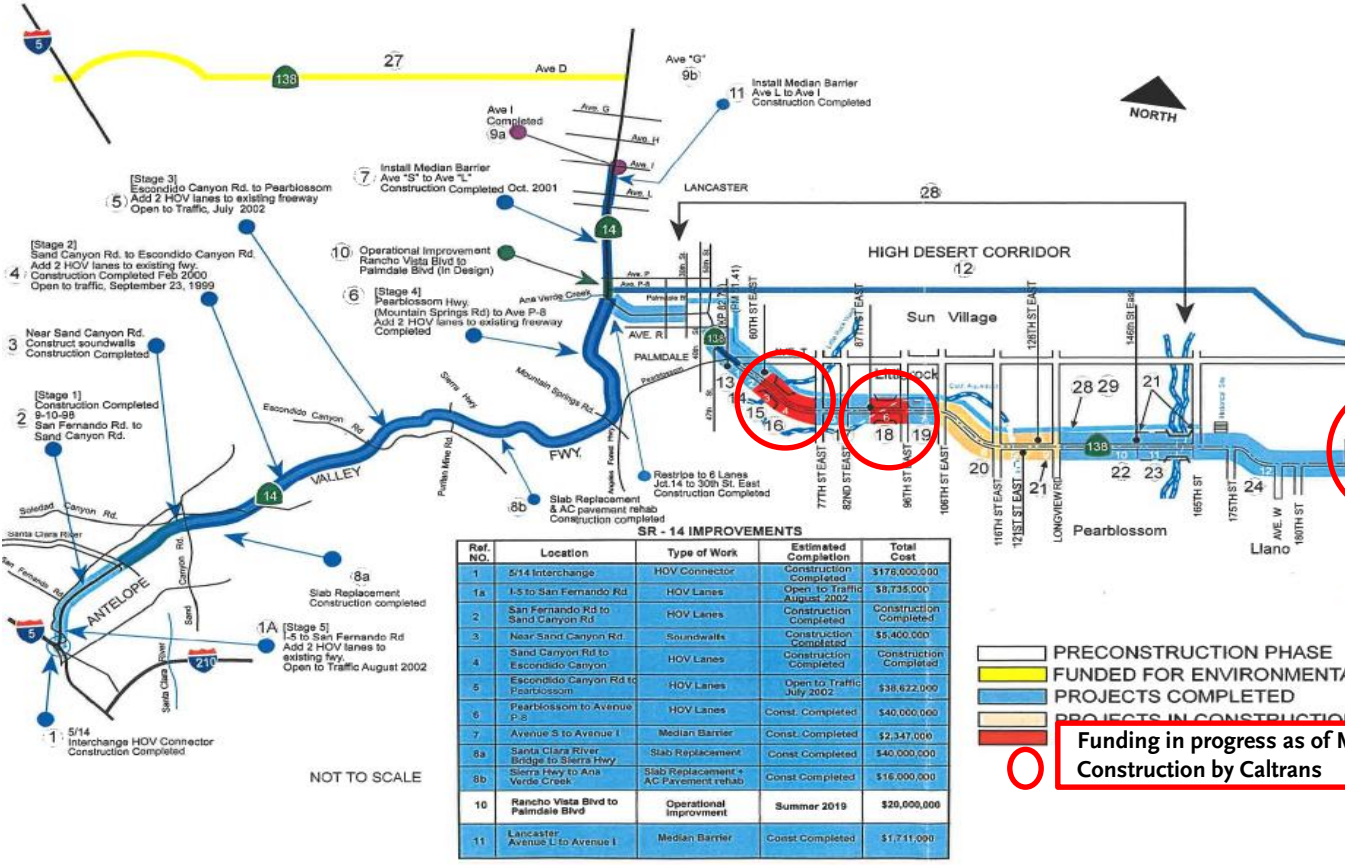

| Ref. NO. | Location | Type of Work | Estimated Completion | Total Cost |
|----------|--|--------------------------------------|-----------------------------|------------------------|
| 1 | 5/14 Interchange | HOV Connector | Construction Completed | \$178,000,000 |
| 1A | J-5 to San Fernando Rd | HOV Lanes | Open to Traffic August 2002 | \$8,735,000 |
| 2 | San Fernando Rd to Sand Canyon Rd | HOV Lanes | Construction Completed | Construction Completed |
| 3 | Near Sand Canyon Rd | Soundwalls | Construction Completed | \$5,400,000 |
| 4 | Sand Canyon Rd to Escondido Canyon | HOV Lanes | Construction Completed | Construction Completed |
| 5 | Escondido Canyon Rd to Pearblossom | HOV Lanes | Open to Traffic July 2002 | \$38,622,000 |
| 6 | Pearblossom to Avenue P-8 | HOV Lanes | Const. Completed | \$40,000,000 |
| 7 | Avenue S to Avenue I | Median Barrier | Const. Completed | \$2,347,000 |
| 8A | Santa Clara River Bridge to Sierra Hwy | Slab Replacement | Const. Completed | \$40,000,000 |
| 8B | Sierra Hwy to Ana Verde Creek | Slab Replacement + AC Pavement rehab | Const. Completed | \$16,000,000 |
| 10 | Rancho Vista Blvd to Palmdale Blvd | Operational Improvement | Summer 2019 | \$20,000,000 |
| 11 | Lancaster Avenue L to Avenue I | Median Barrier | Const. Completed | \$1,711,000 |

| Ref. NO. | Location | Type of Work | Status | Estimated Cost |
|----------|---|---|------------------|-----------------|
| 12 | LA-14 to SB-18 High Desert Corridor | Multi-phase | In Progress | \$1,000,000,000 |
| 13 | From Ave R to 60th St (Extended Seg-1) | Pavement Rehabilitation | Completed | \$1,000,000 |
| 14 | From 60th St. to E of Ave T (Seg. 2) | Widen to 4 lanes | Completed | \$10,000 |
| 15 | From 0.3 mile West of Little Rock Wash to 77th St. Combine Seg. 3 & 4 | Widen to 4 lanes | Not funded | \$24,500 |
| 16 | From 77th St to 87th St (Seg. 5) | Widen to 3 lanes | Completed | \$11,500 |
| 18 | 87th St. to 96th St (Seg. 6) | Widen to 4 lanes | Not funded | \$32,000 |
| 19 | From 96th St to 106th St (Seg. 7) | Widen to 4 lanes | Summer 2009 | \$10,000 |
| 20 | from 0.7 mile West of 121st St. to Longview Rd. Combine Segs 8&9 | Widen to 4 lanes | Fall 2018 | \$20,200 |
| 22 | From Longview Rd to 145th St (Seg. 10) | Replace Bridge and Widen Highway to 4 lanes | Completed | \$9,000 |
| 23 | Twin Bridge (Seg. 11) | Widen to 4 lanes | Completed | \$24,000 |
| 24 | From 165th to 190th St. (Seg. 12) | Widen to 4 lanes | Completed | \$39,811 |
| 25 | From 185th St. to SR-18 Junction (Seg. 13) | Widen to 4 lanes | Not funded | \$62,000 |
| 26 | Jet 18 to SB County Line | Widen roadway and Pave Boulder | Summer 2017 | \$30,300 |
| 27 | I-5 to LA 14 | Widen to 6 lanes | PAID Summer 2017 | \$1,100,000 |
| 28 | LA-138 from 30th St E to 185th St E | Cold plane and overlay | Completed | \$19,200 |
| 29 | LA-138 from 30th St E to 155th St E | ADA compliance | Winter 2019 | \$12,000 |



Highway-Related Projects

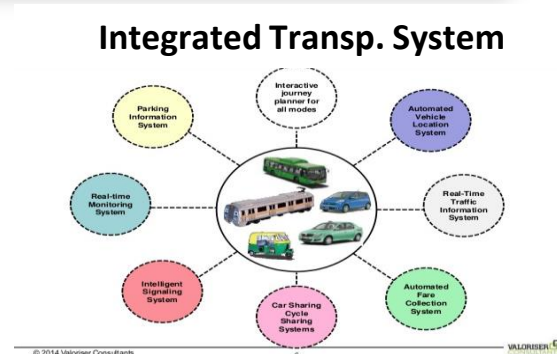
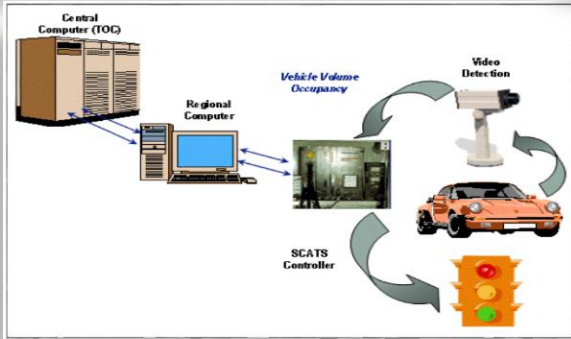

Bucket 1 – Work to Continue

Health and safety for customers and employees

- PPE
- Cleaning services
- Additional expenses directly related to COVID-19

Operating and maintaining bus and rail services per Transit Operations Plan

Federal and State regulatory required activities

Legally required payments (contractual obligations)

- Debt service
- Subsidies
- Licenses, utilities, rental, etc.

Major infrastructure and projects under executed contracts

- Airport Metro Connector ⁽¹⁾
- Crenshaw/LAX ⁽¹⁾
- Division 20 Portal Widening and Turnback
- Gold Line Foothill Extension ⁽¹⁾
- I-5 North HOV (along SR-134 to Buena Vista area) ⁽¹⁾
- I-5 South HOV (I-605 to Orange County line) ⁽¹⁾
- Light Rail Vehicle Acquisition Program
- Link US (Phase 1 only)
- Metro Bus Fleet Replacement (incl. electrification for buses and infrastructure for Orange Line)
- Patsaouras Bus Station
- Purple Line Extension ⁽¹⁾
- Regional Connector ⁽¹⁾
- Soundwall Package 11 ⁽¹⁾
- SR-138 Corridor project in construction ⁽¹⁾
- Willowbrook/Rosa Parks Station Upgrade & Mezzanine



Metro

Bucket 2 - Projects to be Delayed

Highway / Street Improvements

- Adams Flyover
- Alameda Corridor East grade separation phase 2 ⁽¹⁾
- Centinela grade separation
- Countywide Soundwall Noise Studies ⁽¹⁾
- Eastside Light Rail Access ⁽¹⁾
- First / Last Mile (PLE and others) ⁽¹⁾
- I-105 ExpressLanes ⁽¹⁾
- I-210 Barriers
- I-5 Capacity Enhancements (SR14 to Parker Road) ⁽¹⁾
- I-5 Corridor Improvement I-605 to I-710 ⁽¹⁾
- I-605 Hotspots (incl SR-91 interchange) ⁽¹⁾
- I-710 South Corridor Project ⁽¹⁾
- L.A. River (Bike) Path ⁽¹⁾
- La Canada Soundwalls
- Rail to Rail ATP
- Rail to River ATP
- Rosecrans/Marquardt Grade Separation ⁽¹⁾
- Soundwall Packages 12, 13, and 14 ⁽¹⁾
- South Bay Highway Operational Improvements ⁽¹⁾
- SR-138 new project initiation documents ⁽¹⁾
- SR-57 / SR-60 Interchange Improvements ⁽¹⁾
- SR-71 GAP - Mission Blvd to San Bernardino County Line ⁽¹⁾



Metro

Discussions

